



NPPCA
Providing The Concrete Solution

- DESIGN NOTES:
1. CONCRETE 5,000 PSI @ 28 DAYS
 2. REINFORCING ASTM A-615 GRADE 60 #5 REBAR 12" O.C.B.W. OR EQUAL
 3. STRUCTURE DESIGNED FOR H-20 LOADING



**SCITUATE
COMPANIES**

120 CLAY PIT ROAD
MARSHFIELD, MA 02050
PHONE # 1-800-440-0009
FAX # 781-837-4320

CONTRACTOR:

JOB NAME:

DATE: 10/16/2017

APPROVED BY:

DRAWING BY: JOHN KASPER

30,000 GALLON TUNNEL TANK

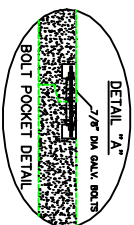
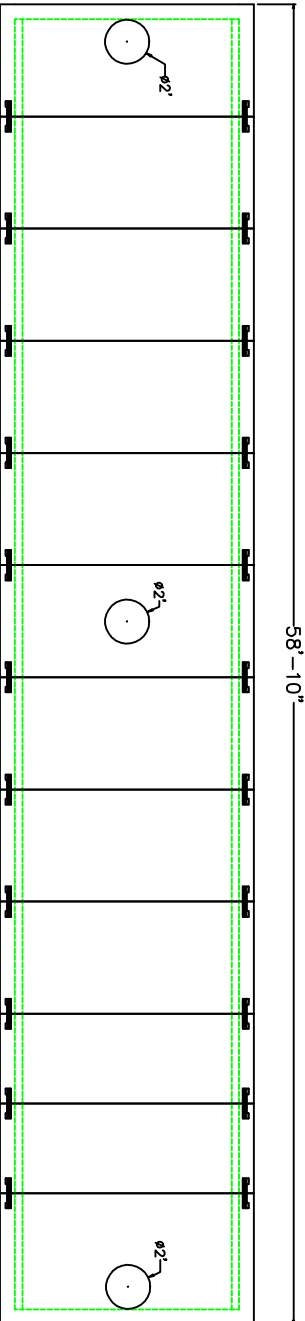

	END WALL	LINEAR FT
WEIGHT	10,300 lbs.	3,800 lbs.
VOLUME		525 gal.

